

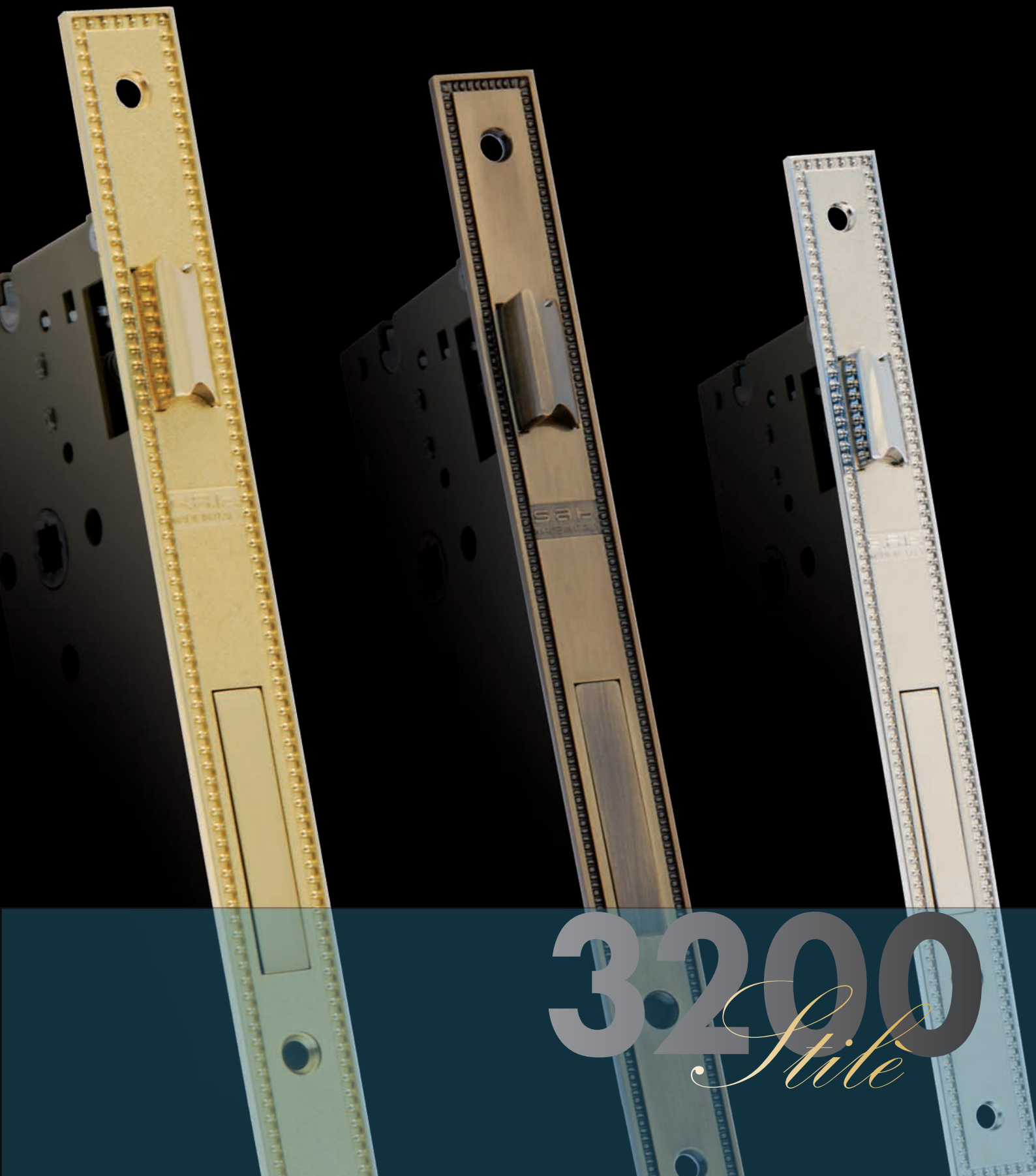

**Serrature da infilare a cilindro | Scatola Chiusa | Stile PRIMO IMPERO e MANIERISMO**

*Mortice locks for profile cylinder | Closed Lock Case | FIRST EMPIRE and MANNERISM style*



**3200**  
*Stile*

# Stilé



## La Serratura

Da elemento funzionale a oggetto di **decorazione** e **valorizzazione** della porta

Ancora oggi la serratura è spesso concepita come puro elemento funzionale, elemento il più possibile nascosto, e utilizzato per il solo scopo di garantire protezione e sicurezza, al più privacy.

L'idea di renderla "oggetto d'arredo", con una qualità ineccepibile, è la nostra filosofia. Questo grazie all'adozione di una placca non più anonima, destinata a tutte le porte, a tutte le maniglie senza distinzione di foggia, stile e finitura, ma dotata di un proprio design che rende la serratura "parte integrante" del corredo di ogni porta: maniglia, cerniere, fermaporta ecc.

Le piastre delle serrature della serie *Stilé* sono ottenute mediante forgiatura a caldo dell'ottone e realizzate seguendo canoni stilistici precisi che le rendono accoppiabili a maniglie appartenenti ai periodi del **Manierismo** (Italia 1530 – 1580), del **Primo Impero** (Francia 1805 – 1820) e a qualche esempio di maniglie Stile '900. La possibilità inoltre di ottenere la placca della serratura in finiture coordinate alle maniglie evidenzia, insieme agli elementi decorativi, l'importanza della funzione estetica.

## The Lock

From a functional element to an object of **decoration** and **enhancement** for the door

Even today, the lock is often thought of as a purely functional element, remaining as hidden as possible, and used for the sole purpose of ensuring protection, security, and privacy.

The idea of making it a "piece of furniture", with the highest standards, is our philosophy. This is done by adopting a plate no longer anonymous for all doors, handles all without distinction of style, style and finish, but with its own design that makes the lock an integral part of each door handle, hinge, door stop etc..

The plates from our series of locks *Stilé* are produced by forging hot brass. They make clear the following stylistic canons similar to the handles from the periods of Mannerism (Italy 1530 - 1580), the First Empire (France from 1805 to 1820) and some examples of 'Style' handles 900. The possibility of getting the plate of the lock in matching finishes highlights, together with decorative elements, the importance of the aesthetic function.





# Stilé

*Manierismo*

*Primo Impero*





Stilé

**3200 STILÈ - MANIERISMO**

Catenaccio e Scrocco | Catenaccio Antistrappo e Scrocco  
 Rullo Registrabile  
 1-2 Mandate  
 Azionamento a cilindro, quadro 8 o chiave patent

Bolt and latch | Tamper Proof Bolt and latch  
 Adjustable roller  
 1-2 Turns  
 Cylinder movement, Square 8 or Patent Key

Piastra frontale in Ottone forgiata a caldo - Stile MANIERISMO

Hot forged Brass Frontal Plate - MANNERISM Style

FINITURA DI SERIE

- Piastra frontale, Catenaccio, Scrocco o Rullo OLV

STANDARD FINISHINGS

- Front plate, Bolt, Latch or Roller OLV

DOTAZIONE

- Contropiastra con aletta Art. 357 OLV
- Vaschetta coprifresata scrocco e catenaccio Art. C371
- Viti di fissaggio
- CILINDRO ESCLUSO

ACCESSORIES

- Striking plate with tab Art. 357 OLV
- Plastic bolt and latch milling cover Art. C371
- Fixing screws
- CYLINDER NOT INCLUDED



Serie **3200 Stilè - MANIERISMO**

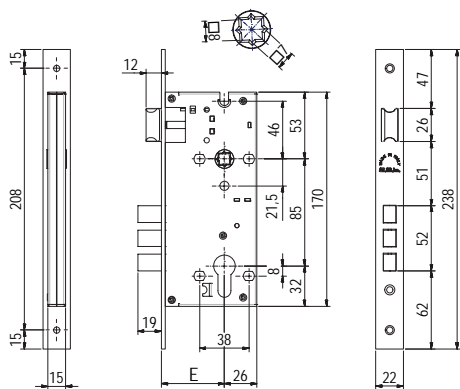

**M3200/85**  
**M3205/85**

Catenaccio Antistrappo e Scrocco | 1-2 Mandate | Azionamento a cilindro | Frontale Stile MANIERISMO  
 Tamper proof bolt and latch | 1-2 Turns | Cylinder movement | Frontal Plate MANNERISM Style

Codice Code	Finitura Finishing					
M3200 85 45 ___ 7	---					45
M3200 85 50 ___ 7	---					50
M3200 85 60 ___ 7	---	2				60
M3200 85 70 ___ 7	---					70
M3200 85 80 ___ 7	---		22x3x238	85		80
M3205 85 45 ___ 7	---					45
M3205 85 50 ___ 7	---					50
M3205 85 60 ___ 7	---	1				60
M3205 85 70 ___ 7	---					70
M3205 85 80 ___ 7	---					80

Finiture Standard | Standard Finishings

Finitura Finishing	OLV	PLO	AG	OCL	ONC	OGR OGM
---						

Serrature da infilare a cilindro | Scatola Chiusa | MANIERISMO  
 Mortice locks for profile cylinder | Closed lock case | MANNERISM

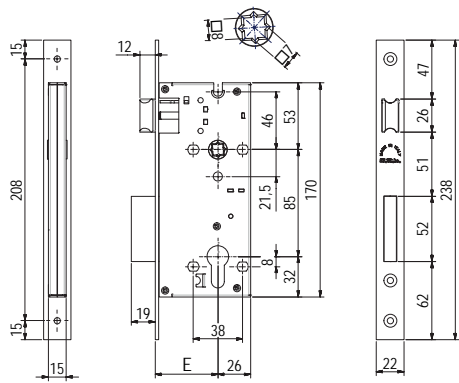

**M3210/85**  
**M3215/85**

Catenaccio e Scrocco | 1-2 Mandate | Azionamento a cilindro | Frontale Stile MANIERISMO

Bolt and Latch | 1-2 Turns | Cylinder movement | Frontal Plate MANNERISM Style

Codice Code	Finitura Finishing					
M3210 85 40 ___ 7						40
M3210 85 45 ___ 7						45
M3210 85 50 ___ 7						50
M3210 85 60 ___ 7						60
M3210 85 70 ___ 7						70
M3210 85 80 ___ 7		2				80
M3215 85 40 ___ 7			22x3x238	85		40
M3215 85 45 ___ 7						45
M3215 85 50 ___ 7						50
M3215 85 60 ___ 7						60
M3215 85 70 ___ 7						70
M3215 85 80 ___ 7		1			1	80
M3215 85 40 ___ 7						20

Finiture Standard | Standard Finishes

Finitura Finishing	OLV	PLO	AG	OCL	ONC	OGR OGM
---						

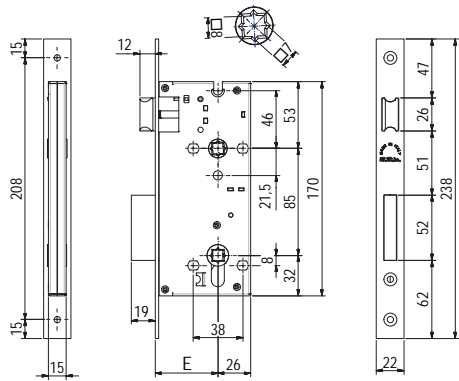

**M3216/85**

Serratura per bagno | Doppio quadro 8mm | Catenaccio e Scrocco | 1 Mandata | Azionamento quadro 8mm | Frontale Stile MANIERISMO

Bathroom lock | Double square hole 8mm | Bolt and Latch | 1 Turn | Square hole movement | Frontal Plate MANNERISM Style

Codice Code	Finitura Finishing					
M3216 85 40 ___ 7						40
M3216 85 45 ___ 7						45
M3216 85 50 ___ 7						50
M3216 85 60 ___ 7		1	22x3x238	85		60
M3216 85 70 ___ 7						70
M3216 85 80 ___ 7						80

Finiture Standard | Standard Finishes

Finitura Finishing	OLV	PLO	AG	OCL	ONC	OGR OGM
---						

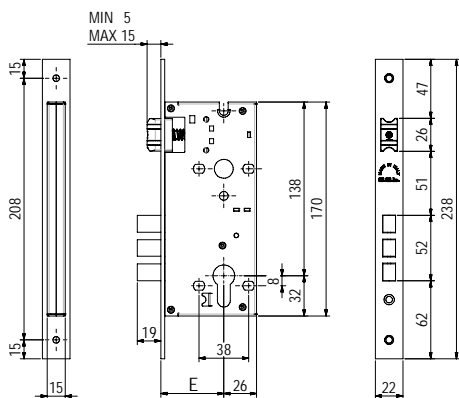

**M3202**  
**M3207**

Catenaccio Antistrappo | Rullo registrabile | 1-2 Mandate | Azionamento a cilindro | Frontale Stile MANIERISMO

Tamper proof bolt | Adjustable roller | 1-2 Turns | Cylinder movement | Frontal Plate MANNERISM Style

Codice Code	Finitura Finishing					
M3202 45 ___ 7						45
M3202 50 ___ 7						50
M3202 60 ___ 7						60
M3202 70 ___ 7						70
M3202 80 ___ 7		2				80
M3207 45 ___ 7			22x3x238			45
M3207 50 ___ 7						50
M3207 60 ___ 7						60
M3207 70 ___ 7		1				70
M3207 80 ___ 7						80

Finiture Standard | Standard Finishes

Finitura Finishing	OLV	PLO	AG	OCL	ONC	OGR OGM
---						

Serie  
**3200 Stilé - MANIERISMO**



Serrature da infilare a cilindro | Scatola Chiusa | MANIERISMO  
Mortice locks for profile cylinder | Closed lock case | MANNERISM

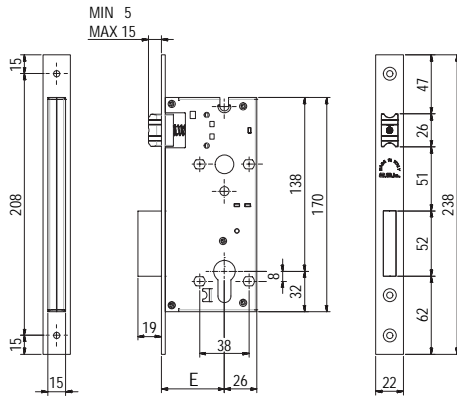

**M3212**  
**M3217**

Catenaccio | Rullo registrabile | 1-2 Mandate | Azionamento a cilindro | Frontale Stile MANIERISMO

Bolt | Adjustable roller | 1-2 Turns | Cylinder movement | Frontal Plate MANNERISM Style

Codice Code	Finitura Finishing					
M3212 40 ___ 7						40
M3212 45 ___ 7						45
M3212 50 ___ 7						50
M3212 60 ___ 7		2				60
M3212 70 ___ 7						70
M3212 80 ___ 7			22x3x238			80
M3217 40 ___ 7						40
M3217 45 ___ 7						45
M3217 50 ___ 7		1				50
M3217 60 ___ 7						60
M3217 70 ___ 7						70
M3217 80 ___ 7						80

Finiture Standard | Standard Finishings

Finitura Finishing	OLV	PLO	AG	OCL	ONC	OGR OGM
---						

Versioni Speciali / Special Type

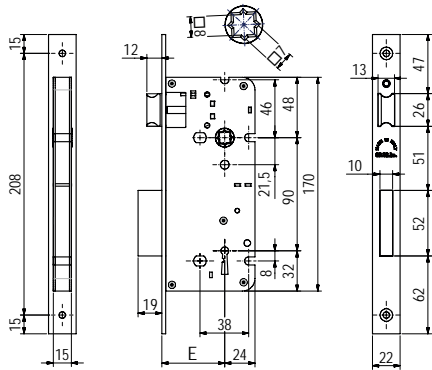

**M2260/90**  
**M2265/90**

Catenaccio e Scrocco | 1-2 Mandate | Azionamento con Chiave Patent | Frontale Stile MANIERISMO

Bolt and Latch | 1-2 Turns | Patent Key movement | Frontal Plate MANNERISM Style

Codice Code	Finitura Finishing					
M2260 90 40 ___ 7						40
M2260 90 45 ___ 7						45
M2260 90 50 ___ 7		2				50
M2260 90 60 ___ 7			22x3x238			60
M2265 90 40 ___ 7				90		40
M2265 90 45 ___ 7						45
M2265 90 50 ___ 7		1				50
M2265 90 60 ___ 7						60

\* Gli articoli M2260-M2265 sono solo con scatola aperta | Articles M2260-M2265 are available only with open lock case

Finiture Standard | Standard Finishings

Finitura Finishing	OLV	PLO	AG	OCL	ONC	OGR OGM
---						





Serie  
**3200 Stilé - MANIERISMO**



Serrature da infilare a cilindro | Scatola Chiusa | MANIERISMO  
Mortice locks for profile cylinder | Closed lock case | MANNERISM

**3200 STILÈ - PRIMO IMPERO**

Catenaccio e Scrocco | Catenaccio Antistrappo e Scrocco  
 Rullo Registrabile  
 1-2 Mandate  
 Azionamento a cilindro, Quadro 8mm, Chiave Patent

Bolt and latch | Tamper Proof Bolt and latch  
 Adjustable roller  
 1-2 Turns  
 Cylinder movement, Square 8 or Patent Key

Piastra frontale in Ottone forgiata a caldo - Stile PRIMO IMPERO

Hot forged Brass Frontal Plate - FIRST EMPIRE Style

FINITURA DI SERIE

- Piastra frontale, Catenaccio, Scrocco o Rullo OLV

STANDARD FINISHINGS

- Front plate, Bolt, Latch or Roller OLV

DOTAZIONE

- Contropiastra con aletta Art. 357 OLV
- Vaschetta coprifresata scrocco e catenaccio Art. C371
- Viti di fissaggio
- CILINDRO ESCLUSO

ACCESSORIES

- Striking plate with tab Art. 357 OLV
- Plastic bolt and latch milling cover Art. C371
- Fixing screws
- CYLINDER NOT INCLUDED



Serie 3200 Stilè - PRIMO IMPERO

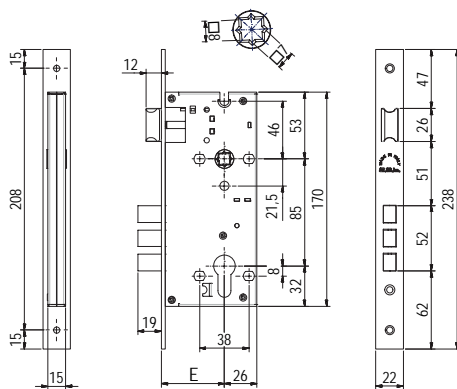

**P3200/85  
P3205/85**

Catenaccio Antistrappo e Scrocco | 1-2 Mandate | Azionamento a cilindro | Frontale Stile PRIMO IMPERO  
 Tamper proof bolt and latch | 1-2 Turns | Cylinder movement | Frontal Plate PRIMO IMPERO Style

Codice Code	Finitura Finishing					
P3200 85 45 ___ 7	---					45
P3200 85 50 ___ 7	---					50
P3200 85 60 ___ 7	---	2				60
P3200 85 70 ___ 7	---					70
P3200 85 80 ___ 7	---		22x3x238	85		80
P3205 85 45 ___ 7	---					45
P3205 85 50 ___ 7	---					50
P3205 85 60 ___ 7	---	1				60
P3205 85 70 ___ 7	---					70
P3205 85 80 ___ 7	---					80

Finiture Standard | Standard Finishings

Finitura Finishing	OLV	PLO	AG	OCL	ONC	OGR OGM
---						

Serrature da infilare a cilindro | Scatola Chiusa | PRIMO IMPERO  
 Mortice locks for profile cylinder | Closed lock case | FIRST EMPIRE

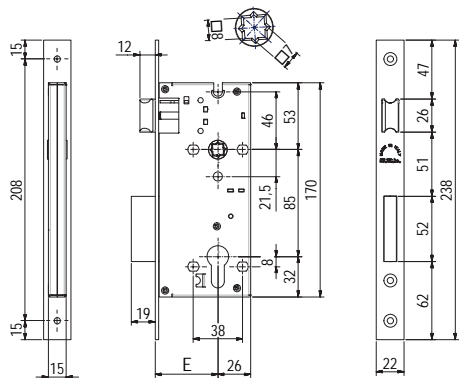

**P3210/85**  
**P3215/85**

Catenaccio e Scrocco | 1-2 Mandate | Azionamento a cilindro | Frontale Stile PRIMO IMPERO

Bolt and Latch | 1-2 Turns | Cylinder movement | Frontal Plate PRIMO IMPERO Style

Codice Code	Finitura Finishing						
P3210 85 40 ___ 7	---						
P3210 85 45 ___ 7	---						
P3210 85 50 ___ 7	---						
P3210 85 60 ___ 7	---						
P3210 85 70 ___ 7	---						
P3210 85 80 ___ 7	---						
P3215 85 40 ___ 7	---						
P3215 85 45 ___ 7	---						
P3215 85 50 ___ 7	---						
P3215 85 60 ___ 7	---						
P3215 85 70 ___ 7	---						
P3215 85 80 ___ 7	---						

Finiture Standard | Standard Finisings

Finitura Finishing	OLV	PLO	AG	OCL	ONC	OGR OGM
---						

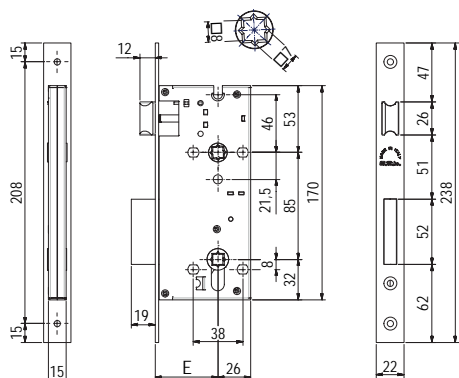

**P3216/85**

Serratura per bagno | Doppio quadro 8mm | Catenaccio e Scrocco | 1 Mandata | Azionamento quadro 8mm | Frontale Stile PRIMO IMPERO

Bathroom lock | Double square hole 8mm | Bolt and Latch | 1 Turn | Square hole movement | Frontal Plate PRIMO IMPERO Style

Codice Code	Finitura Finishing						
P3216 85 40 ___ 7	---						
P3216 85 45 ___ 7	---						
P3216 85 50 ___ 7	---						
P3216 85 60 ___ 7	---						
P3216 85 70 ___ 7	---						
P3216 85 80 ___ 7	---						

Finiture Standard | Standard Finisings

Finitura Finishing	OLV	PLO	AG	OCL	ONC	OGR OGM
---						

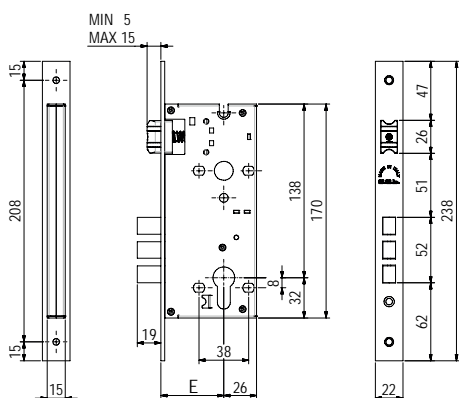

**P3202**  
**P3207**

Catenaccio Antistrappo | Rullo registrabile | 1-2 Mandate | Azionamento a cilindro | Frontale Stile PRIMO IMPERO

Tamper proof bolt | Adjustable roller | 1-2 Turns | Cylinder movement | Frontal Plate PRIMO IMPERO Style

Codice Code	Finitura Finishing						
P3202 45 ___ 7	---						
P3202 50 ___ 7	---						
P3202 60 ___ 7	---						
P3202 70 ___ 7	---						
P3202 80 ___ 7	---						
P3207 45 ___ 7	---						
P3207 50 ___ 7	---						
P3207 60 ___ 7	---						
P3207 70 ___ 7	---						
P3207 80 ___ 7	---						

Finiture Standard | Standard Finisings

Finitura Finishing	OLV	PLO	AG	OCL	ONC	OGR OGM
---						

Serie  
**3200 Stilé - PRIMO IMPERO**



Serrature da infilare a cilindro | Scatola Chiusa | PRIMO IMPERO  
Mortice locks for profile cylinder | Closed lock case | FIRST EMPIRE

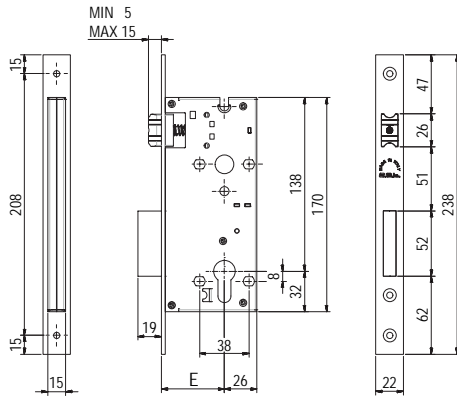

**P3212**  
**P3217**

Catenaccio | Rullo registrabile | 1-2 Mandate | Azionamento a cilindro | Frontale Stile PRIMO IMPERO

Bolt | Adjustable roller | 1-2 Turns | Cylinder movement | Frontal Plate PRIMO IMPERO Style

Codice Code	Finitura Finishing					
P3212 40 ___ 7						40
P3212 45 ___ 7						45
P3212 50 ___ 7						50
P3212 60 ___ 7		2				60
P3212 70 ___ 7						70
P3212 80 ___ 7			22x3x238			80
P3217 40 ___ 7						40
P3217 45 ___ 7						45
P3217 50 ___ 7		1				50
P3217 60 ___ 7						60
P3217 70 ___ 7						70
P3217 80 ___ 7						80

Finiture Standard | Standard Finishings

Finitura Finishing	OLV	PLO	AG	OCL	ONC	OGR OGM
---						

Versioni Speciali / Special Type

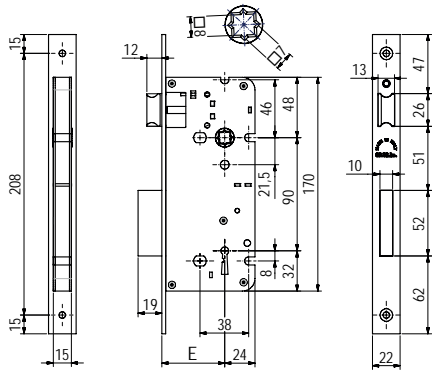

**P2260/90**  
**P2265/90**

Catenaccio e Scrocco | 1-2 Mandate | Azionamento con Chiave Patent | Frontale Stile PRIMO IMPERO

Bolt and Latch | 1-2 Turns | Patent Key movement | Frontal Plate PRIMO IMPERO Style

Codice Code	Finitura Finishing					
P2260 90 40 ___ 7						40
P2260 90 45 ___ 7						45
P2260 90 50 ___ 7		2				50
P2260 90 60 ___ 7			22x3x238			60
P2265 90 40 ___ 7				90		40
P2265 90 45 ___ 7						45
P2265 90 50 ___ 7		1				50
P2265 90 60 ___ 7						60

\* Gli articoli P2260-P2265 sono solo con scatola aperta | Articles P2260-P2265 are available only with open lock case

Finiture Standard | Standard Finishings

Finitura Finishing	OLV	PLO	AG	OCL	ONC	OGR OGM
---						

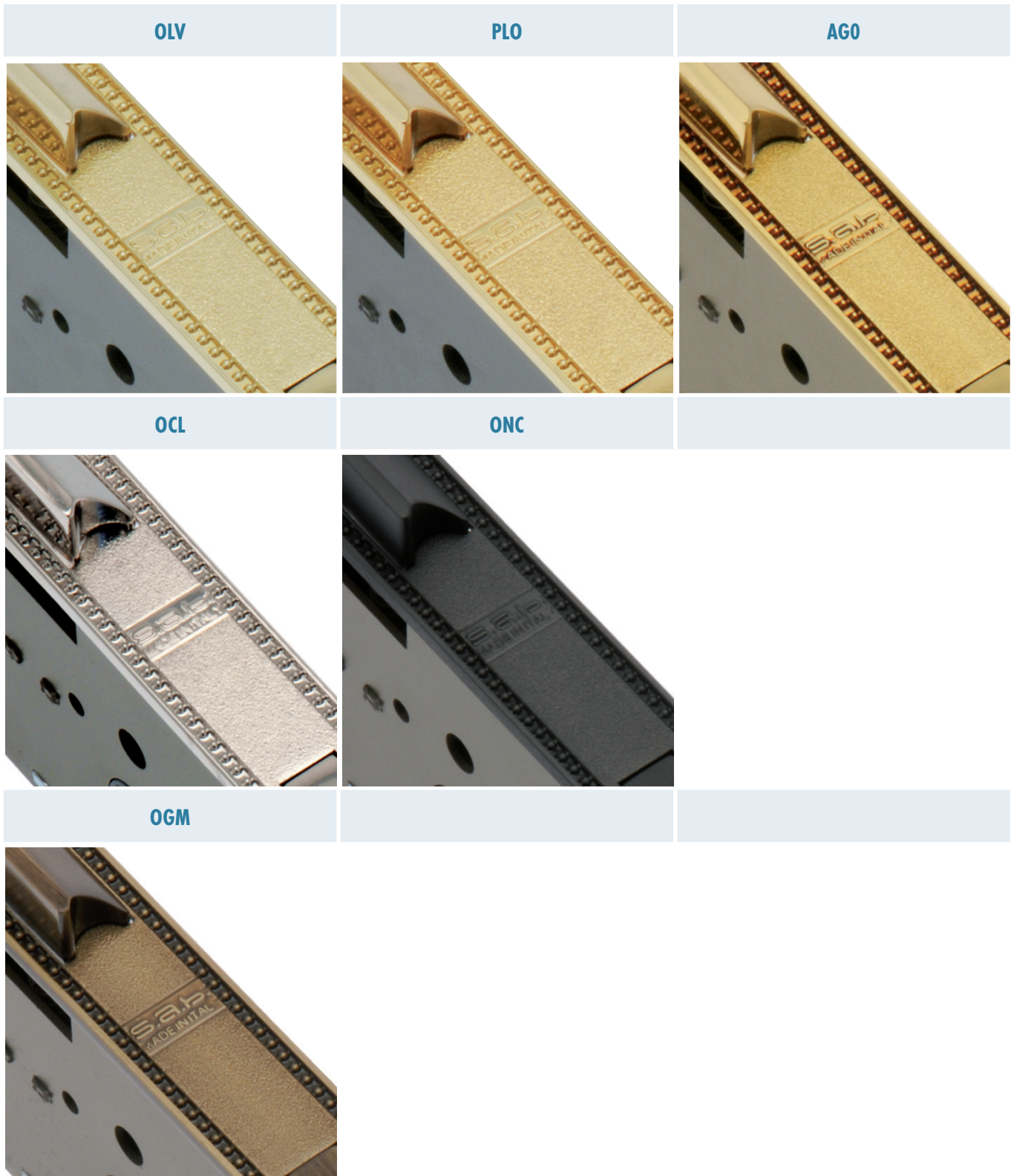

Serie  
**3200 Stilé - PRIMO IMPERO**



Serrature da inflare a cilindro | Scatola Chiusa | PRIMO IMPERO  
Mortice locks for profile cylinder | Closed lock case | FIRST EMPIRE